

Please Approve this Drawing

| | |
|-----------|--|
| Date | |
| Signature | |

| REVISIONS | | | |
|-----------|-----------------|----------------|------------|
| NO. | DESCRIPTION | ECN NO. | DATE |
| | INITIAL RELEASE | ECN-2201405001 | 2014.05.05 |
| △ | Add to Ball | ECN-2201405026 | 2014.05.22 |

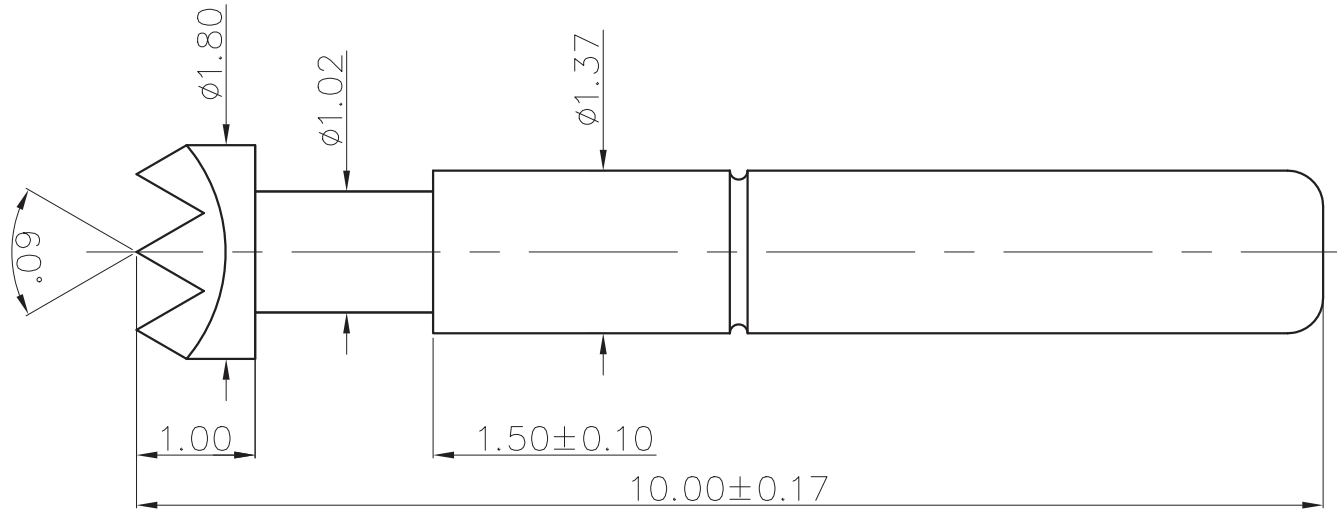

NOTE;

- Material
 - Plunger: BeCu Au Plated
 - Barrel: Brass Au Plated
 - Spring: SUS304 Not Au Plated
 - Ball: SUS △
- Electrical
 - Rated current : 3A Max.
 - Contact resistance: 100 mohm maximum at working stroke(quiescence)
- Mechanical
 - Full stroke: 1.50 mm
 - Spring Force : $80g \pm 20\%$ at 1.00 mm working stroke
 - Durability: 100,000 cycles(minimum)
- Harmful material control please follow DOC. NO."DQ03050"

| | | | | | | | |
|---------------------------------------|---------------------|--------|------------------|--|-----|-------------------------------------|-----------|
| DRAWN | linyushou | SCALE: | 1 : 1 | UNIT | mm | DRAWING NO. | S-6H-0511 |
| CHECKED | | SHEET: | 1 of 1 | PROJECT | | TITLE. Test Probe | |
| APPROVED | | DATE: | 2014.05.22 | VER. | A.1 | | |
| THE UNMARKED TOLERANCE ARE AS BELOW : | | | | | | C.C.P. (DG) CONTACT PROBES CO.,LTD. | |
| LENGTH | | ANGLE | | 东莞中探探针有限公司 | | | |
| 0~6.0 | $\pm 0.05\text{mm}$ | 0. | $\pm 2.0^\circ$ | The information in this document is property of C.C.P company and should not be copied or reproduced in any other way, without written permission. | | | |
| >6~30 | $\pm 0.10\text{mm}$ | 0.0 | $\pm 1.0^\circ$ | | | | |
| >30~120 | $\pm 0.15\text{mm}$ | 0.00 | $\pm 0.50^\circ$ | | | | |